

MANUAL PELLETSTOVE

Your glamping tent is equipped with a pellet stove, this stove works on wood pellets. This short manual contains a number of steps to be able to use the stove.

Preparation

1. Check whether there are enough wood pellets in the stove. A valve can be opened at the top of the stove, which must contain sufficient wood pellets.
2. If necessary, you can buy additional pellets at the reception. You enter these at the top of the stove.

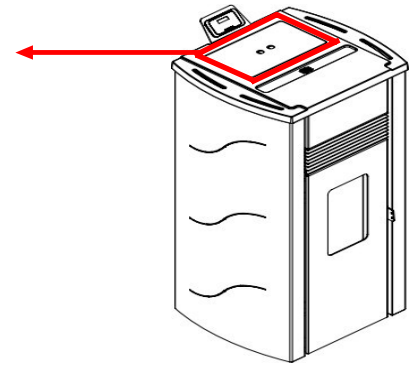

Switch on the stove

1. The control panel is located on the top of the stove. Switch the stove, press button C until a beep sounds.
2. The heater will now start up.
Note: this can take a few minutes!
Wait until the stove is fully on before pressing any button!
3. When the stove is at sufficient temperature, the fan will switch on automatically to distribute the heat.



Switch off the stove

1. To switch off the stove, press button C until a beep sounds.
2. The heater will now switch off.
3. The stove will now burn up the remaining pellets and the fan will run faster. **This can take several minutes!**

