

Operating manual washing machine

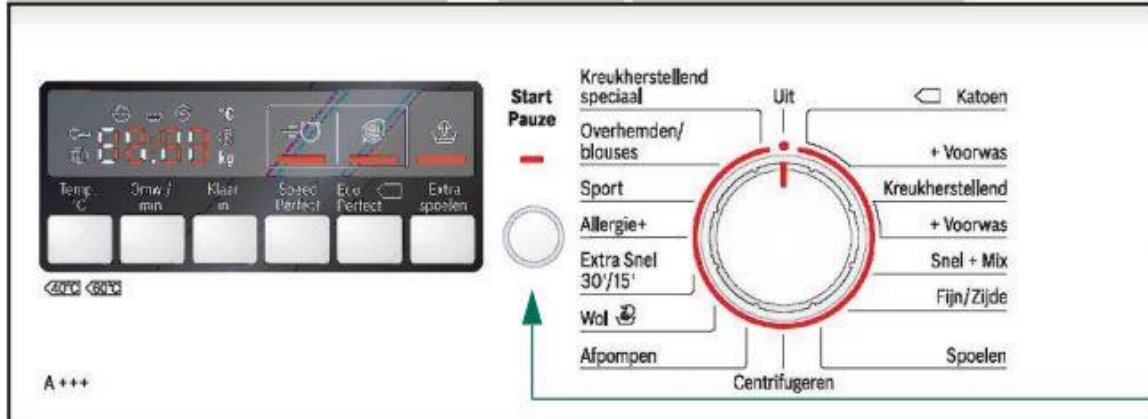

Starting a programme

- Place your laundry in the machine.
- Add detergent and/or fabric softener.
- Turn the programme knob ('programmakiezer') and set the programme.

The related programme indicator comes on.

- If necessary, you can change the spin speed, with the button under 'centrifugetoerental', or add one of the available options on the left side of the machine.

When you activate an option, the indicator of the set option comes on.

- Press 'Start/Bijvullen' to start the programme.

The programme starts, the door is locked and a key is shown on the display.

Ending a programme

At the end of the programme, a 0 is shown on the display. The door lock indicator (the key) goes off.

- You can now remove the laundry from the appliance.
- Please turn the programme knob ('programmakiezer') back to off (UIT).